

Metron 05 VT

METAL DETECTION

METAL DETECTOR FOR VIBRATORY CONVEYORS

Reliable *in Process and Detection*
Durable *in Technology and Performance*
Easy *in Installation and Handling*



- No 'metal free zone' required
- Highly sensitive to ferrous, non-ferrous and stainless steel
- Quick and easy installation
- User friendly operation
- Models to fit every application
- No matter which shape your trough, we have the right size metal detector!

Applications

Machinery protection
e.g. chippers

Installation

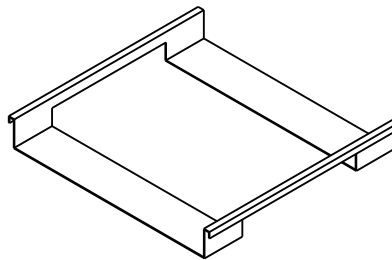
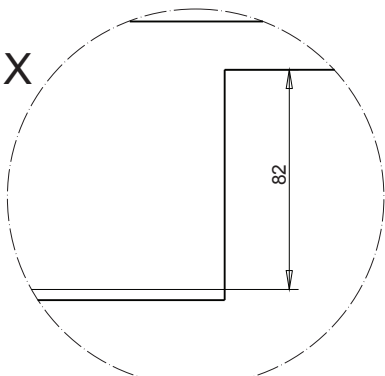
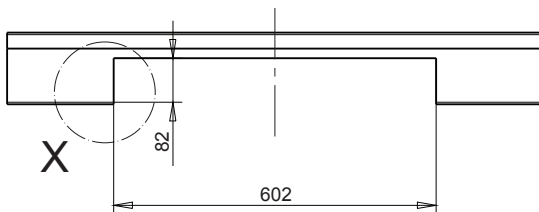

- Cut the trough according to the drawing.
- Install the sensing coil.
- Allow for movement of the interconnecting cables (coil to electronics).
- Form a 20 cm (8") loop with the transmitter/receiver cables at the coil end.

